

## Accessories



**Filament bulbs** Ba 9s base Catalog No. of current: AC/DC. A lamp changing tool is required for changing bulb.

Description					Catalog No.	Ref. Code	List Price
Rated voltage V	Rated current mA	Rated output W	Service life h	Lumina-nance mcd			
6	200	1.2	10 000	350	<b>5911 086-11</b>	5911 086-11	<b>\$ 6.00</b>
12	100	1.2	10 000	230	<b>5911 086-12</b>	5911 086-12	
24	50	1.2	10 000	280	<b>5911 086-13</b>	5911 086-13	
30	40	1.2	10 000	250	<b>5911 086-4</b>	5911 086-4	
48	42	2	6 000	500	<b>5911 086-5</b>	5911 086-5	
60	20	1.2	5 000	190	<b>5911 086-14</b>	5911 086-14	
110	18	2	7 500	250	<b>5911 086-7</b>	5911 086-7	
130	15	2	7 500	120	<b>5911 086-15</b>	5911 086-15	

### LEDs

With one diode chip mounted on a Ba 9s base. Choose the same color for the LED and the lamp cap or else use a clear lamp cap.

For white light use white LED with clear lamp cap. At DC the lamp base have to be connected to cathode (-) and the bottom contact to anode (+).



Color	Rated current mA	Wave-length nM	Lumi-nance mcd	Catalog No.	Ref. Code	List Price
<b>Rated voltage 12 V, DC</b> Service life >50 000 h						
Red	15	630	250	<b>KA2-2011</b>	1SFA 616 921 R2011	<b>\$ 21.00</b>
Green	15	525	1000	<b>KA2-2012</b>	1SFA 616 921 R2012	
Yellow	15	592	250	<b>KA2-2013</b>	1SFA 616 921 R2013	
Blue	15	470	450	<b>KA2-2014</b>	1SFA 616 921 R2014	
White	15	x=0.31 y=0.32	600	<b>KA2-2015</b>	1SFA 616 921 R2015	
<b>Rated voltage 24 V, (AC)/DC</b> Ⓢ Service life >50 000 h						
Red	15	630	250	<b>KA2-2021</b>	1SFA 616 921 R2021	<b>15.00</b>
Green	15	525	800	<b>KA2-2022</b>	1SFA 616 921 R2022	
Yellow	15	592	250	<b>KA2-2023</b>	1SFA 616 921 R2023	
Blue	15	470	400	<b>KA2-2024</b>	1SFA 616 921 R2024	
White	15	x=0.31 y=0.32	500	<b>KA2-2025</b>	1SFA 616 921 R2025	
<b>Rated voltage 48 V, (AC)/DC</b> Ⓢ Service life >50 000 h						
Red	12	630	200	<b>KA2-2041</b>	1SFA 616 921 R2041	<b>21.00</b>
Green	12	525	1700	<b>KA2-2042</b>	1SFA 616 921 R2042	
Yellow	12	592	240	<b>KA2-2043</b>	1SFA 616 921 R2043	
Blue	12	470	720	<b>KA2-2044</b>	1SFA 616 921 R2044	
White	12	x=0.31 y=0.32	1200	<b>KA2-2045</b>	1SFA 616 921 R2045	
<b>Rated voltage 60 V, (AC)/DC</b> Ⓢ Service life >50 000 h						
Red	10	630	160	<b>KA2-2051</b>	1SFA 616 921 R2051	<b>21.00</b>
Green	10	525	1400	<b>KA2-2052</b>	1SFA 616 921 R2052	
Yellow	10	592	200	<b>KA2-2053</b>	1SFA 616 921 R2053	
Blue	10	470	600	<b>KA2-2054</b>	1SFA 616 921 R2054	
White	10	x=0.31 y=0.32	1000	<b>KA2-2055</b>	1SFA 616 921 R2055	
<b>Rated voltage 110-130 V, AC</b> Ⓢ Service life 25 000 h						
Red	4-6	630	60-100	<b>KA2-2131</b>	1SFA 616 921 R2131	<b>15.00</b>
Green	4-6	525	500-850	<b>KA2-2132</b>	1SFA 616 921 R2132	
Yellow	4-6	592	70-120	<b>KA2-2133</b>	1SFA 616 921 R2133	
Blue	4-6	470	220-350	<b>KA2-2134</b>	1SFA 616 921 R2134	
White	4-6	x=0.31 y=0.32	350-600	<b>KA2-2135</b>	1SFA 616 921 R2135	
<b>Rated voltage 110-130 V, AC/DC</b> Ⓢ Service life 25 000 h						
Red	4-6	630	60-100	<b>KA2-2141</b>	1SFA 616 921 R2141	<b>21.00</b>
Green	4-6	525	500-850	<b>KA2-2142</b>	1SFA 616 921 R2142	
Yellow	4-6	592	70-120	<b>KA2-2143</b>	1SFA 616 921 R2143	
Blue	4-6	470	220-350	<b>KA2-2144</b>	1SFA 616 921 R2144	
White	4-6	x=0.31 y=0.32	350-600	<b>KA2-2145</b>	1SFA 616 921 R2145	
<b>Rated voltage 230 V, AC</b> Ⓢ Service life 25 000 h						
Red	4	630	60	<b>KA2-2221</b>	1SFA 616 921 R2221	<b>21.00</b>
Green	4	525	500	<b>KA2-2222</b>	1SFA 616 921 R2222	
Yellow	4	592	70	<b>KA2-2223</b>	1SFA 616 921 R2223	
Blue	4	470	220	<b>KA2-2224</b>	1SFA 616 921 R2224	
White	4	x=0.31 y=0.32	350	<b>KA2-2225</b>	1SFA 616 921 R2225	

Ⓢ At AC the luminance is decreased with 30 % and there is also a slight flickering.

# Accessories

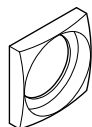
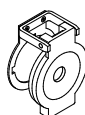
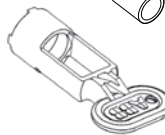
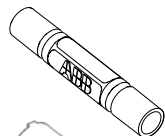

## Lamp changing tool

Description	Catalog No.	Ref. Code	List Price
For LEDs and for bulbs	<b>KA1-8072</b>	1SFA 616 920 R8072	\$ 10.00

## Mounting tool

Description	Catalog No.	Ref. Code	List Price
Used for tightening the locking nut	<b>KA1-8015</b>	1SFA 611 920 R8015	\$ 10.00

## Membrane of silicone

Of transparent, heat and cold resistant silicon rubber. Does not harden at low temperature. Gives IP 67 degree of protection. When membrane is used, remove the gasket.

For operator with	Catalog No.	Ref. Code	List Price
Flush button	<b>KA1-8052</b>	1SFA 616 920 R8052	\$ 8.00
Extended button	<b>KA1-8002</b>	1SFA 616 920 R8002	8.00

## Protective ring

Description	Catalog No.	Ref. Code	List Price
For flush and extended pushbutton To prevent inadvertant operation. Not together with legend plate holder.	<b>SK 615 512-1</b>	SK 615 512-1	\$ 4.00

## Protective cover

Description	Catalog No.	Ref. Code	List Price
For flush button. To prevent inadvertant operation. Not together with legend plate holder.	<b>KA1-8010</b>	1SFA 616 920 R8010	\$ 15.00

## Button

Description	Catalog No.	Ref. Code	List Price
Grey, flush (Packing unit 10 pieces)	<b>KA1-8087</b>	1SFA 616 920 R8087	\$ 1.50
Grey, extended (Packing unit 10 pieces)	<b>KA1-8097</b>	1SFA 616 920 R8097	1.50

## Bezel

Description	Catalog No.	Ref. Code	List Price
<b>For pushbutton</b>			
Grey (Packing unit 10 pieces)	<b>KA1-8079</b>	1SFA 616 920 R8079	\$ 1.00
Black (Packing unit 10 pieces)	<b>KA1-8022</b>	1SFA 616 920 R8022	1.00
Metal (Packing unit 10 pieces)	<b>KA1-8021</b>	1SFA 616 920 R8021	2.50
<b>For selector switch</b>			
Grey (Packing unit 10 pieces)	<b>CA1-8076</b>	1SFA 619 920 R8076	1.00
Black (Packing unit 10 pieces)	<b>CA1-8077</b>	1SFA 619 920 R8077	1.00
Metal (Packing unit 10 pieces)	<b>CA1-8078</b>	1SFA 619 920 R8078	2.50

## Square bezel

Black, plastic (Packing unit 10 pieces)	<b>SK 616 016-2</b>	SK 616 016-2	2.00
Grey, plastic (Packing unit 10 pieces)	<b>KA1-8124</b>	1SFA 611 920 R8124	2.00

## Blanking plug (22mm)

Description	Catalog No.	Ref. Code	List Price
Grey plastic	<b>MA1-8129</b>	1SFA 611 920 R8129	\$ 5.80
Black plastic	<b>MA1-8130</b>	1SFA 611 920 R8130	5.80

## Blanking plug (30mm)

Description	Catalog No.	Ref. Code	List Price
Black plastic	<b>MA1-8133</b>	1SFA 611 920 R8133	7.30

## Accessories



### 30 mm adaptors

For use when fitting the 22 mm pilot devices in 30 mm mounting holes. (1.5 – 4 mm panels)

Description	Catalog No.	Ref. Code	List Price
<b>For use with pushbuttons, selector switches, emergency stop push-button and pilot lights</b> Black plastic.	<b>KA1-8029</b>	1SFA 616 920 R8029	<b>\$ 8.00</b>
	<b>KA1-8030</b>	1SFA 616 920 R8030	<b>10.00</b>

### Adaptors

<b>For flush mounted pushbutton</b>	<b>KA1-8073</b>	1SFA 616 920 R8073	<b>15.00</b>
<b>For flush mounted selector switches</b>	<b>CA1-8075</b>	1SFA 619 920 R8075	

### Extra key

Description	Catalog No.	Ref. Code	List Price
Ronis 455 (key code 71)	<b>SK 616 021-71</b>	SK 616 021-71	<b>\$ 10.00</b>