

D-Trip Characteristic



UL508 Listed
E137938

Application Examples:

High inrush motors, transformers, power supplies, heaters and reactive loads.
Relatively long thermal trip delay and very high magnetic trip point.



One Pole

Standard Pack: 12

Weight:

0.3A - 32A
1.75kg (3.86 lb.)
40A - 63A
2.07kg (4.56 lb.)

Rated Current	Type/ Cat. No.	Approvals
0.3A	1D03UM	UL SF VDE
0.5A	1D05UM	UL SF VDE
0.75A	1D075UM	UL SF VDE
0.8A	NA	
1.0A	1D1UM	UL SF VDE
1.6A	1D1.6UM	UL SF VDE
2.0A	1D2UM	UL SF VDE
2.5A	1D2.5UM	UL SF VDE
3.0A	1D3UM	UL SF VDE
3.5A	1D3.5UM	UL SF VDE
4.0A	1D4UM	UL SF VDE
5.0A	1D5UM	UL SF VDE
6.0A	1D6UM	UL SF VDE
8.0A	1D8UM	UL SF VDE
10A	1D10UM	UL SF VDE
12A	NA	
13A	1D13UM	UL SF VDE
15A	1D15UM	UL SF VDE
16A	1D16UM	UL SF VDE
20A	1D20UM	UL SF VDE
25A	1D25UM	UL SF VDE
30A	1D30UM	UL SF VDE
32A	1D32UM	UL SF VDE
40A	1D40UM	UL SF VDE
50A	1D50UM	UL SF VDE
60A	1D60UM	UL SF VDE
63A	1D63UM	UL SF VDE



Three Pole

Standard Pack: 4

Weight:

0.3A - 32A
1.75kg (3.86 lb.)
40A - 63A
2.07kg (4.56 lb.)

Rated Current	Type/ Cat. No.	Approvals
0.3A	3D03UM	UL SF VDE
0.5A	3D05UM	UL SF VDE
0.75A	3D075UM	UL SF VDE
0.8A	NA	
1.0A	3D1UM	UL SF VDE
1.6A	3D1.6UM	UL SF VDE
2.0A	3D2UM	UL SF VDE
2.5A	3D2.5UM	UL SF VDE
3.0A	3D3UM	UL SF VDE
3.5A	3D3.5UM	UL SF VDE
4.0A	3D4UM	UL SF VDE
5.0A	3D5UM	UL SF VDE
6.0A	3D6UM	UL SF VDE
8.0A	3D8UM	UL SF VDE
10A	3D10UM	UL SF VDE
12A	NA	
13A	3D13UM	UL SF VDE
15A	3D15UM	UL SF VDE
16A	3D16UM	UL SF VDE
20A	3D20UM	UL SF VDE
25A	3D25UM	UL SF VDE
30A	3D30UM	UL SF VDE
32A	3D32UM	UL SF VDE
40A	3D40UM	UL SF VDE
50A	3D50UM	UL SF VDE
60A	3D60UM	UL SF VDE
63A	3D63UM	UL SF VDE



Two Pole

Standard Pack: 6

Weight:

0.3A - 32A
1.75kg (3.86 lb.)
40A - 63A
2.07kg (4.56 lb.)

Rated Current	Type/ Cat. No.	Approvals
0.3A	2D03UM	UL SF VDE
0.5A	2D05UM	UL SF VDE
0.75A	2D075UM	UL SF VDE
0.8A	NA	
1.0A	2D1UM	UL SF VDE
1.6A	2D1.6UM	UL SF VDE
2.0A	2D2UM	UL SF VDE
2.5A	2D2.5UM	UL SF VDE
3.0A	2D3UM	UL SF VDE
3.5A	2D3.5UM	UL SF VDE
4.0A	2D4UM	UL SF VDE
5.0A	2D5UM	UL SF VDE
6.0A	2D6UM	UL SF VDE
8.0A	2D8UM	UL SF VDE
10A	2D10UM	UL SF VDE
12A	NA	
13A	2D13UM	UL SF VDE
15A	2D15UM	UL SF VDE
16A	2D16UM	UL SF VDE
20A	2D20UM	UL SF VDE
25A	2D25UM	UL SF VDE
30A	2D30UM	UL SF VDE
32A	2D32UM	UL SF VDE
40A	2D40UM	UL SF VDE
50A	2D50UM	UL SF VDE
60A	2D60UM	UL SF VDE
63A	2D63UM	UL SF VDE



Add-on Neutral Pole

Rating	Type/ Cat. No.	Approvals
0.3-63A/ 480Y/277V	N63UM	UL SF

Standard Pack: 5

Weight:
0.775kg (1.71lb.)

Standard Dual Connection Terminal

- Box clamp terminals
Top: 18-3 AWG;
Bottom: 18-2 AWG
(Line/Load reversible)

- Ring tongue terminals

Dimensions*:

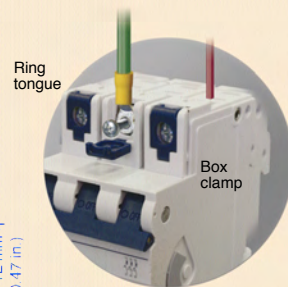
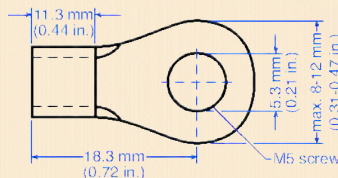

* May differ by manufacturer.
Top terminal ring tongue maximum thickness 1.6 mm.